

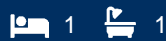

# morton.

**Sydney** 415/27 Park Street



Positioned on level 41 in 'Park Regis', this renovated one bedroom apartment boasts spectacular views over Hyde Park that stretch across glistening waters to Sydney Heads. Drenched in morning sunlight this open plan layout features living and dining with separate kitchen. The perfect investment or city pad.

- Bedroom with built-in robes and ensuite
- Open plan kitchen, living and dining
- Timber floors, large windows
- Currently leased at \$550pw
- Stunning views from every room
- 2 minute walk to Town Hall Train Station
- Onsite building manager, shared laundry
- 5\* facilities include roof top terrace and pool, table tennis, BBQ

### View

As advertised or by appointment

### Agent

**Ettiene West**

📞 0410 593 749

✉️ ettiene@morton.com.au

[morton.com.au](http://morton.com.au)

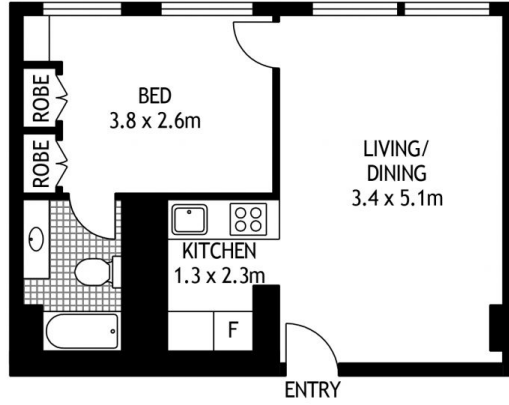

LEVEL FORTY ONE

415/27 PARK STREET

SYDNEY

SCAPE Floor Planning Disclaimer: This floor plan is conceptual only, it is provided for illustrative purposes only and should not be relied upon. We make no guarantees to the correctness of this plan. All interested parties should make and rely on their own enquiries in determining the accuracy of the information contained in this floor plan.