



morton.

Pyrmont 702/66 Bowman Street

 2  2  1

A superb lifestyle package in the highly regarded Fleetview building makes this generous apartment an inspired choice for buyers and investors whose top priority is blue-chip positioning. Fresh, bright and displaying a smart contemporary style, it captures the essence of easycare harbourside living with good proportions, designer finishes and leafy outlooks over Refinery Square.

- Air-conditioned interiors with lounge and dining areas
- Private entertainers' balcony with leafy parkland views
- Main bedroom with walk-thru wardrobe and ensuite
- Well-appointed modern kitchen and s/steel gas fittings
- Security car space, intercom entrance and lift access
- Access to indoor/outdoor pool, gymnasium and tennis courts
- Short stroll to cafes, local shops, bus transport and parklands

View



As advertised or by appointment

Agents

Ian Qiu

 0447 696 425
 ian@morton.com.au

Natasha Giannone

 0438 683 859
 natasha@morton.com.au

morton.com.au

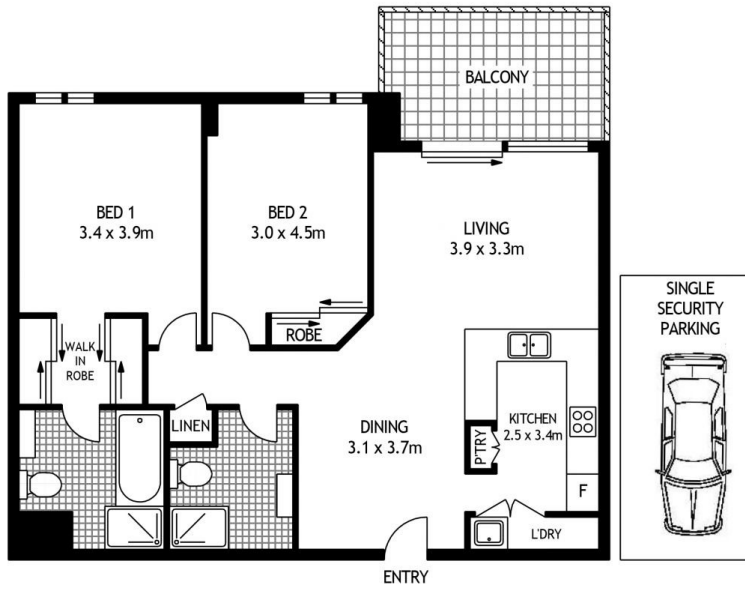

SEVENTH FLOOR



702/66 BOWMAN STREET

PYRMONT

SCAPE Floor Planning Disclaimer: This floor plan is conceptual only. It is provided for illustrative purposes only and should not be relied upon. We make no guarantees to the correctness of this plan. All interested parties should make and rely on their own enquiries in determining the accuracy of the information contained in this floor plan.